

Randburg, Gauteng

**Beautiful and Vibrant Office
To-Let in Ferndale, Randburg**

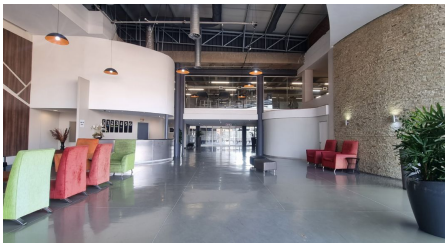
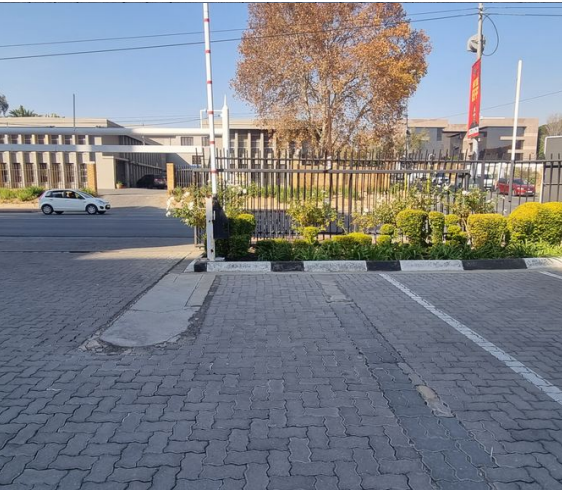

288 Kent is a contemporary, upscale building located centrally in Randburg, featuring an industrial aesthetic. Spanning 5 floors with elevator access, it boasts a spacious communal reception area upon entry.

Each floor includes shared spaces and separate male and female restrooms. The building offers a sizable cafeteria for convenient lunches and an expansive outdoor area for staff relaxation. Situated near public transportation options like Gautrain buses, taxis, and metro buses, it also includes amenities such as a backup generator, 24-hour security, and an onsite gym.

R46,560 PM

excl. VAT & Utilities

price per m²: R80

FEATURES

Gross Monthly Rental R46,560 Excl. VAT
Available From Immediately
Lease Period 36 months

Building Size (m²) 582
Land Size (m²) 8571
Zoning Commercial
Security Yes

Power 3 Phase No
Air Conditioning Yes

**WEB REFERENCE NO.
COM18957**

Go to 3cubeproperty.co.za
for more information about this property



CONTACT
ANGELINE NAIDOO

☎ 073 774 2182 / (010) 3006441

✉ angeline@3cubeproperty.co.za